



Working on
behalf of

HS2

Notice of 24-hour single lane closure and road closure on the A446 southbound

October 2020 | www.hs2.org.uk

High Speed Two (HS2) is the new high speed railway for Britain. Early works for HS2 are carried out by a joint venture between Laing O'Rourke and Murphy & Sons known as LM. In your area, we are working near the A452, A45 and M42, which surround the site of the future HS2 Interchange Station.

We're improving the local road network

During 2020, we are building four new highways bridges in the area that surrounds the future HS2 Interchange Station. In the future, these bridges will connect the current road network to new routes we are creating. The first of these new highways bridges was safely installed in August over the M42. After we install the second of these bridges over the A446 from Friday 23 October to Monday 26 October, we will carry out various activities to reinstate the road. To conduct these safely, we will install a 24-hour single lane closure and then a road closure.

We'll be starting work on Monday 26 October

To carry out this work, we'll first install a temporary 24-hour single lane closure along the A446 southbound from Monday 26 October for approximately five days (see map on next page). If we install the second bridge over the A446 faster than expected, and therefore reopen the A452 and A446 before Monday 26 October, we will install the 24-hour single lane closure from that point. To complete our activities to reinstate the road, when we remove the 24-hour single lane closure, we will install a temporary road closure along the A446 southbound from Friday 30 October for one night (see map on next page).

HS2 during the coronavirus pandemic

We are continually reviewing the works on our construction sites in line with Government and Public Health England (PHE) advice on dealing with coronavirus. The Government's current strategy makes clear that construction activity can continue if it complies with this guidance.

The health and safety of our workforce and the communities we affect is our key priority. Please be assured that those sites that are currently still working are doing so because they can operate within PHE and construction industry guidelines.

If you have a question about HS2 or our works, please contact our HS2 Helpdesk team on 08081 434 434 or email hs2enquiries@hs2.org.uk

Notification



Duration of works

From Monday 26 October for one week in total.

Working hours will be 24-hours.

What to expect

We will temporarily install a 24-hour single lane closure on the A446 southbound.

You will still be able to travel along the A446 in both directions during the single lane closure.

We will then temporarily install one overnight road closure on the A446 southbound.

What we will do

Keep all sites safe and secure.

Leave the area in a tidy state when works are complete.

Maintain building access.

Call our HS2 Helpdesk team on **08081 434 434**

Notice of 24-hour single lane closure and road closure on the A446 southbound



Notification



October 2020 | www.hs2.org.uk

Location of 24-hour single lane closure on the A446 southbound

Key:

-  = temporary lane closure
-  = permanent road closure

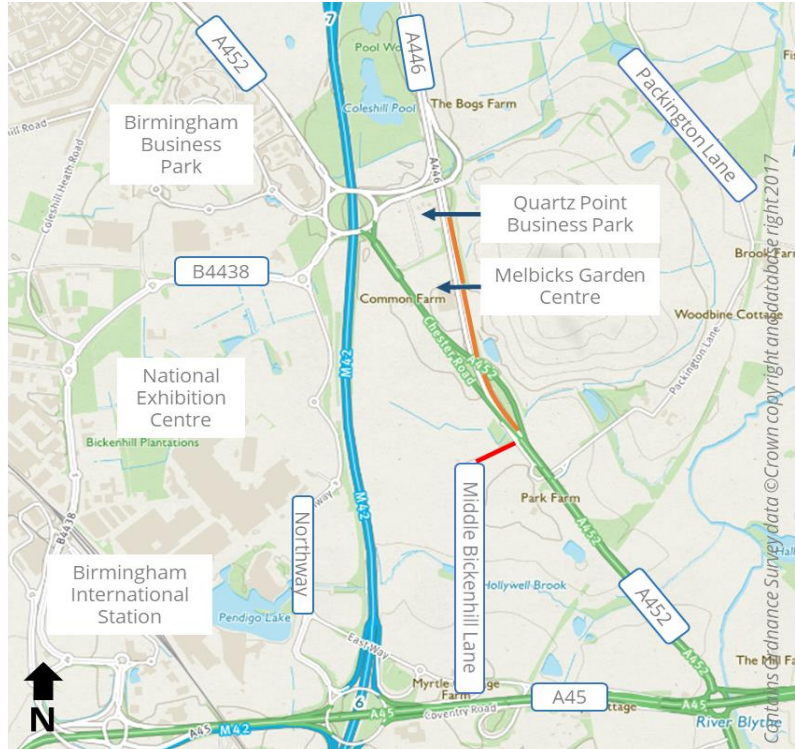

The map on the right outlines the location of our temporary 24-hour single lane closure on the A446 southbound from Monday 26 October for five days.

If we install the second bridge over the A446 faster than expected, and therefore reopen the A452 and A446 before Monday 26 October, we will install the 24-hour single lane closure on the A446 southbound from that point.



Location of road closure on the A446 southbound

Key:

-  = temporary road closure
-  = diversion route
-  = permanent road closure

The map on the right outlines the location of our temporary road closure along the A446 southbound from Friday 30 October for one night.

This road closure will follow the removal of the 24-hour single lane closure outlined above.

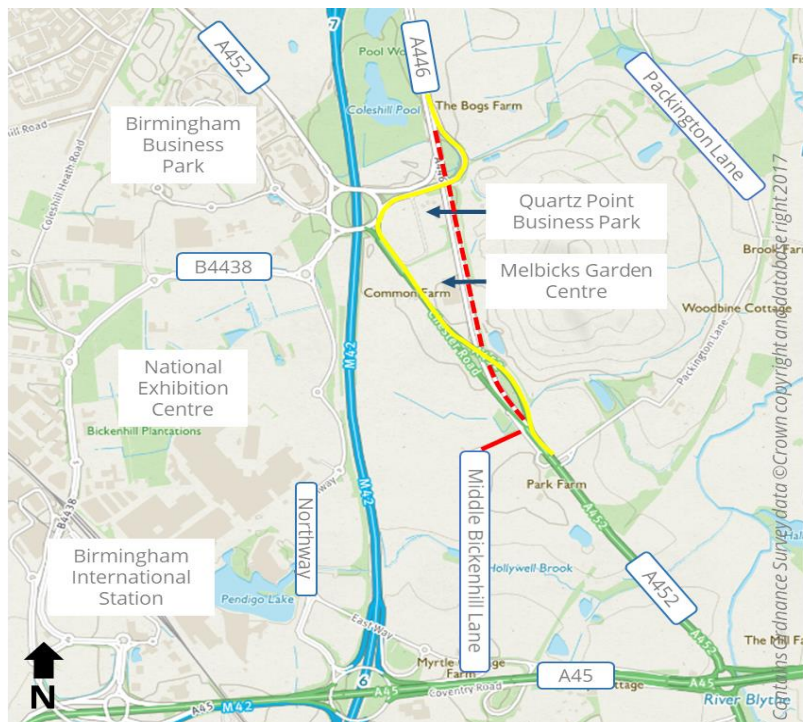

This schedule is subject to change depending on site and weather conditions, and evolving measures to combat coronavirus. We'll keep you informed of any adjustments at: www.hs2insolihull.co.uk

Contact our HS2 Helpdesk team on **08081 434 434**

What else is happening in your area?

October 2020 | www.hs2.org.uk

Responding to the coronavirus pandemic

Following UK government advice to stop non-essential social contact and avoid unnecessary travel during the coronavirus pandemic, **we have taken the decision to postpone our public engagements and events.** We will continue to communicate with you via our regular newsletters, notifications and a programme of virtual events.

The HS2 Helpdesk also remains operational all day, every day, if you need advice or information from HS2. You can contact the Helpdesk on:

Freephone: **08081 434 434**

Minicom: **08081 456 472**

Email: hs2enquiries@hs2.org.uk

Our works programme and traffic measures may change as further guidance from the government is received. We advise subscribing for live news updates about HS2 in Solihull and our programme of virtual events at: www.hs2insolihull.co.uk

About our Community and Business Funds

We are offering two funds that are available to local communities and businesses across Birmingham and the West Midlands, to help with the disruption caused by our construction work. These are the Community and Environment Fund (CEF) and the Business and Local Economy Fund (BLEF).

The CEF is designed to give communities the opportunity to share in the benefits of HS2. It is an allocated fund that communities are able to apply for, to help to support local projects that aim to improve their local area.

The BLEF is designed to support local economies that may be disrupted by the construction of HS2. BLEF grants are for local business support organisations and local authorities to help maintain business activity in local communities.

For more information about each of these funds, including how to apply, please visit: www.groundwork.org.uk/hs2funds



Contact our HS2 Helpdesk team on **08081 434 434**

Keeping you informed

We are committed to keeping you informed about work on HS2. This includes ensuring you know what to expect and when to expect it, as well as how we can help.

Residents' Charter and Commissioner

The Residents' Charter is our promise to communicate as clearly as we possibly can with people who live along or near the HS2 route. www.gov.uk/government/publications/hs2-residents-charter

We also have an independent Residents' Commissioner whose job is to make sure we keep to the promises we make in the Charter and to keep it under constant review. Find reports at: www.gov.uk/government/collections/hs2-ltd-residents-commissioner

You can contact the Commissioner at: residentscommissioner@hs2.org.uk

Construction Commissioner

The Construction Commissioner's role is to mediate and monitor the way in which HS2 Ltd manages and responds to construction complaints. You can contact the Construction Commissioner by emailing: complaints@hs2-cc.org.uk

Property and compensation

You can find out all about HS2 and properties along the line of route by visiting: www.gov.uk/government/collections/hs2-property
Find out if you're eligible for compensation at: www.gov.uk/claim-compensation-if-affected-by-hs2

Holding us to account

If you are unhappy for any reason you can make a complaint by contacting our HS2 Helpdesk team. For more details on our complaints process, please visit our website: www.hs2.org.uk/how-to-complain

Contact Us

Contact our HS2 Helpdesk team all day, every day of the year on:

 Freephone **08081 434 434**

 Minicom **08081 456 472**

 Email **hs2enquiries@hs2.org.uk**

Write to:

FREEPOST

HS2 Community Engagement

Website **www.hs2.org.uk**

To keep up to date with what is happening in your local area, visit: **www.hs2insolihull.co.uk**

Please contact us if you'd like a free copy of this document in large print, Braille, audio or easy read. You can also contact us for help and information in a different language.

HS2 Ltd is committed to protecting personal information. If you wish to know more about how we use your personal information please see our Privacy Notice <https://www.gov.uk/government/publications/high-speed-two-ltd-privacy-notice>